

# **Swordfish**

## **Armoured660D**

### Heavy Duty A3 Laminator

#### For Professional Use



Scan here to  
download or view  
these instructions  
in other languages



Scan here to  
watch a helpful  
hints video



Please read this manual completely before using your laminator as incorrect use can cause serious damage.

# Safety Precautions

Failure to comply with any of the following safety precautions could result in serious injury, fire or electric shock.



This equipment is not intended for use by children. It is not a toy.



Unauthorised attempts at repair will invalidate the warranty.



Do not allow water, or damp media, to enter the laminator.



Do not cover the laminator, or place anything on it. Risk of fire!



Disconnect after use or when cleaning the laminator.



The laminator is hot and contains hazardous moving parts.



Do not operate the laminator on, or near, combustible objects.



Do not allow clothing or jewellery to enter the laminator. Risk of fire or electric shock!



Do not leave the laminator unattended during operation.



Do not use aerosol products on or near this machine (or any other electrical appliance) as the contents may be flammable.

## SPECIFICATIONS

Suitability		Cold Lamination Option	✓
		Auto Shut-Off	✓ / After 30 minutes
		Number of Rollers	4
What makes it special?	High speed, heavy duty	Warm-up Time	4 - 6 minutes
Swordfish UK Product Code	40379	Speed (time to laminate an A4 sheet)	32 seconds
Maximum Paper Size	A3	Working Speed	660mm/minute
Colour	Black/Dark Silver	Working Temperature	50° - 160°C
Feed Entry Width (mm)	320mm	Product Dimensions H x W x D (mm)	112 x 530 x 217
Maximum Pouch Thickness	2 x 250 [500] Microns	Weight (kg)	7.5kg
Maximum Pouch Thickness Total (mm)	1.0mm	Power	A3 - 220/230V 50Hz, 600W, 2.8A
Jam Release	✓		
Reverse Control	✓	Product Warranty (years)	2 years

## Product Warranty Swordfish Laminator

### SWORDFISH 2-YEARS LIMITED WARRANTY FOR PARTS AND LABOUR

Swordfish laminators are warranted against failure or malfunction due to faulty components or workmanship for a period of two years from the date of purchase by the original consumer. Defects or failures, which have been caused by incorrect or wrongful use, regardless whether unintentional or intentional during the operation or maintenance of the device, are excluded from the warranty. There are no user-serviceable parts inside a Swordfish laminator. Unauthorized repair or attempts to service the unit will invalidate the warranty.

For service of the unit under warranty, please return your Swordfish laminator with proof of purchase to your dealer or contact Swordfish customer service. In the event of returning the machine under warranty, suitable packaging must be used. Insufficient packaging resulting in damage will invalidate the warranty.

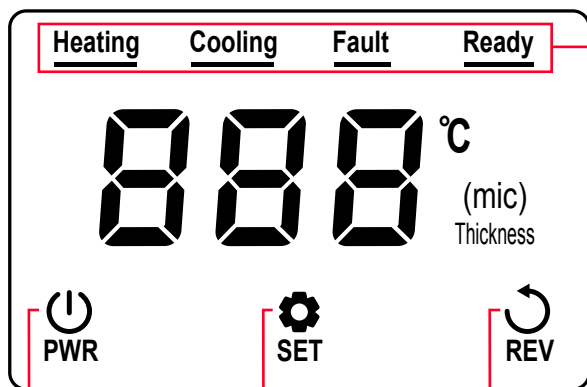
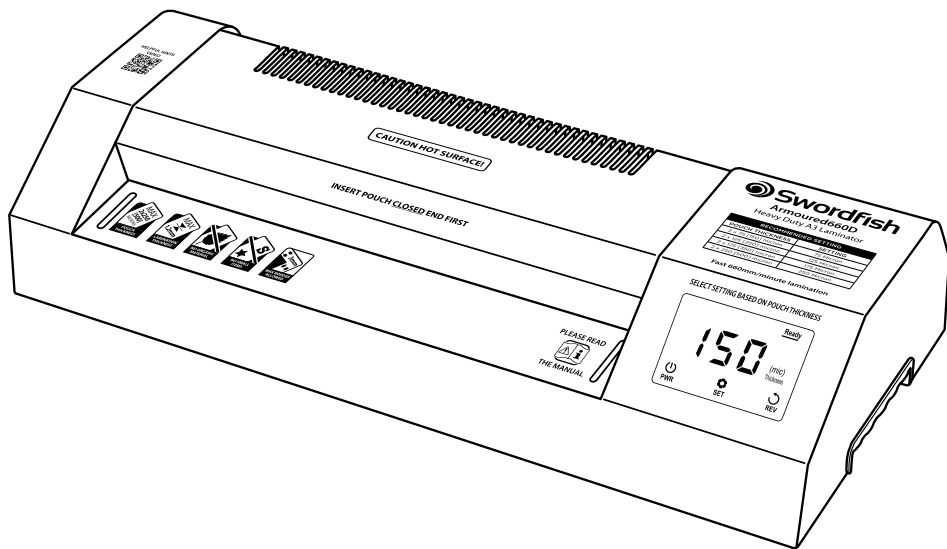

- **'Heating'** will continue flashing whilst the machine increases the temperature
- **'Cooling'** will continue flashing whilst the machine decreases the temperature
- **'Fault'** will be displayed when the machine encounters a problem
- **'Ready'** will be displayed when the machine reaches the desired temperature

- **PWR** indicates that the machine is off  
**PWR** indicates that the machine is operational
- Pouch Thickness / Cold mode selection
- Press **"REV"** to activate the Reverse mode.  
Press **"REV"** again to deactivate the Reverse mode.

Please read this manual completely before using your laminator as incorrect use can cause serious damage. Failure to follow the instructions in this manual could invalidate your warranty!

## Quick Start Guide

- 1** Position the laminator on a suitable flat surface, within easy reach of a 13Amp socket, ensuring that there is sufficient space behind the machine for the laminations to lay flat.
- 2** Connect the laminator to the 13Amp socket and press the isolating switch on the back of the machine to the "on" position. "PWR" will illuminate.
- 3** Press "PWR" to activate the display on the control panel.
- 4** Press "SET" on the control panel to select the required pouch thickness and the machine will start warming up. Setting the temperature too high can cause your pouch to jam!

### NOTE

- The pouch thickness on the Control Panel represents one side thickness of the pouch.
- The maximum lamination thickness is 1.0mm (1000 micron) inclusive of the lamination pouch and the item to be laminated. For example, if the thickness of the lamination pouch is 0.1mm (100 micron) per side (total 0.2mm), the item to be laminated should be less than 0.8mm (800 micron). on the control panel to select the pouch thickness you are using and the machine will start warming up.

- 5** "Ready" will illuminate after 3-4 minutes, followed by an audible beep, depending on the required temperature. Laminating can now begin.

- 6**  You must use the supplied pouch carrier if you intend to laminate any of the following:
  - Multiple items within a single pouch
  - Irregular shaped items
  - Soft material such as newspaper, tissue, paper and fabrics
  - Any item that leaves a border of more than a 3mm around its edges

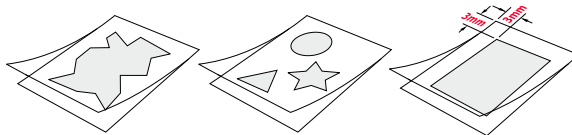

Replacement pouch carriers are available from [www.snopakebrands.com](http://www.snopakebrands.com) or your usual pouch supplier.

- 7** If the lamination is imperfect, adjust the pouch thickness setting to correct the fault – see page 9.
- 8** Before turning off the machine, allow the rollers to cool evenly by putting the machine in the 'Cold' mode. This can be done by pressing "SET" repeatedly until "COL" shows on the control panel. Allow the laminator to run for 5 minutes before turning off the power.

To get the best results from your laminator and extend its working life, please turn to page 6.

# Getting Started

The Swordfish Armoured660 laminators are steel-cased, heavy-duty, variable temperature machines. They are equipped with sophisticated temperature control, large 25.6mm precision rollers and a steel cooling plate – all of which combine to give perfect laminations.

**1** Position the laminator on a level surface, close to a 13Amp socket.



## CAUTION

Do not locate the laminator:

- Near any heat appliances such as heater or stove
- Directly exposed to sunlight
- Close to an air-conditioning unit
- In a poor ventilated environment
- On an irregular or inclined surface

**2** Allow enough space behind the laminator for your laminations to lay flat whilst cooling. Do not cover the machine or place anything on top of it.

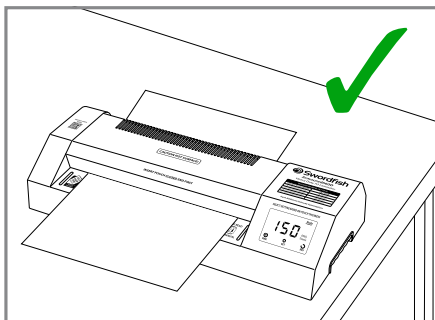
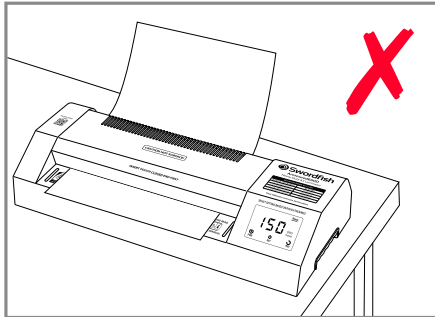

# Operation

- 1 Connect the laminator to the 13Amp socket and turn the isolating switch on the rear of the machine to the "on" position. Press "PWR" on the control panel and the laminator will start to run.

**CAUTION**  
 Do not leave the laminator unattended during lamination.

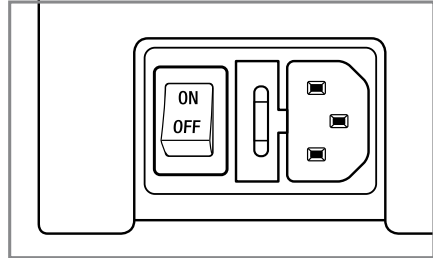

- 2 Press "SET" on the control panel to select the required pouch thickness and the machine will start warming up. Once the pouch thickness has been selected, "Heating" will start flashing at the top of the control panel. "Heating" will stop flashing and "Ready" will appear when the desired temperature has been reached.

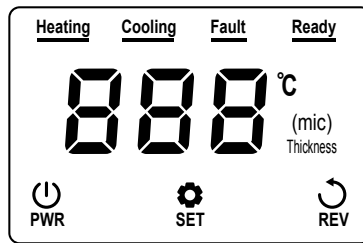

- 3 Prepare the item to be laminated. Insert the item to be laminated into a pouch of the correct size and push it right into the sealed end of the pouch. The pouch could jam if the sealed end is not filled. Always insert the pouch into the laminator sealed end first.

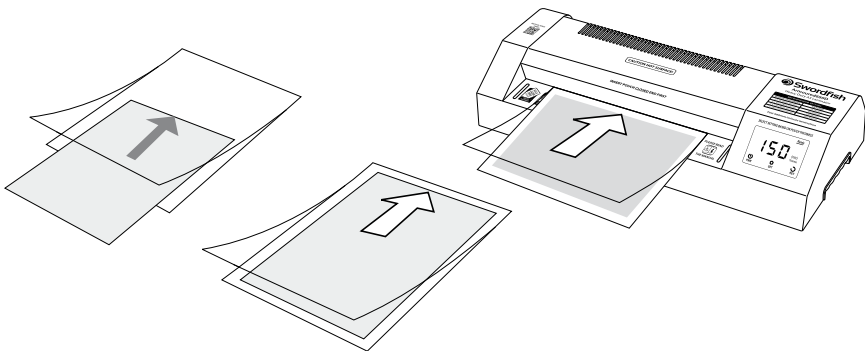

## 4 CAUTION

Lamination pouches are designed for use with full A4, A3, A2 etc. documents. If you wish to laminate non-standard items that do not support the pouch across its entire area, you must use a carrier or there is a real risk that the pouch will jam. Typical instances where a carrier must be used include:

- Multiple items within a single pouch
- Irregular shaped items
- Soft material such as newspaper, tissue, paper and fabrics
- Any item that leaves a border of more than a 3mm around its edges

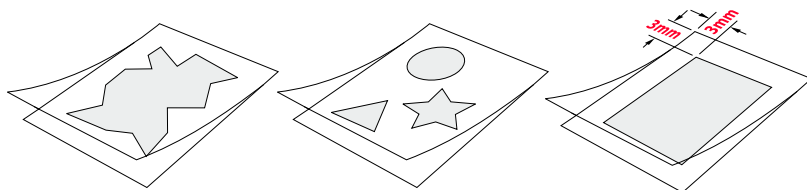

Failure to use a carrier in such cases could cause the pouch to jam. Carriers are available from your usual pouch supplier.

A cardboard carrier will absorb some of the heat so you may need to adjust the temperature settings accordingly.

Swordfish Armoured pouch carriers are made from PTFE-coated micro-fine woven fibreglass and will require little or no temperature adjustment.

Note that the maximum thickness of carrier + pouch + contents **MUST NOT EXCEED 1.0mm**.

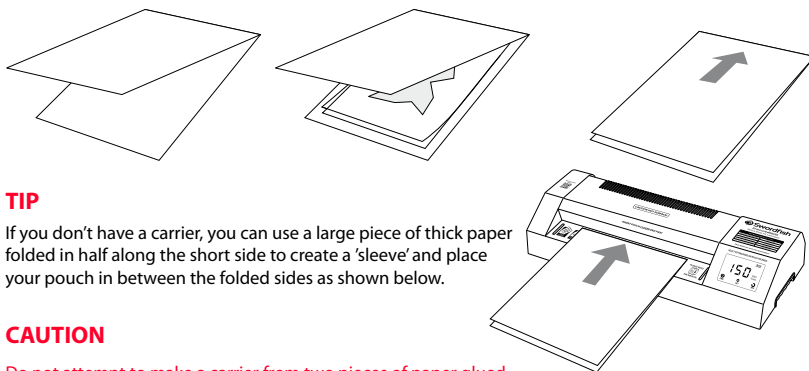

### TIP

If you don't have a carrier, you can use a large piece of thick paper folded in half along the short side to create a 'sleeve' and place your pouch in between the folded sides as shown below.

### CAUTION

Do not attempt to make a carrier from two pieces of paper glued or taped together - it will jam!



**5** The laminated item will be transported out of the laminator automatically.



**CAUTION**

- Do not try to pull the pouch out by force. This may result in creases or curves in the laminated item and may damage the laminator.
- Remove the laminated item and lay it flat.
- The laminated item will be hot. Please handle it with care.

**TIPS**

If the correct settings are not chosen, the following lamination results may appear. Adjust the setting and try again.

**White spots**



Insufficient heat - Increase the temperature a little by selecting the next pouch thickness setting.

**Vertical spots**

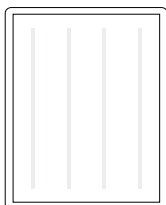

Insufficient heat - Increase the temperature a little by selecting the next pouch thickness setting.

**Clear & smooth**

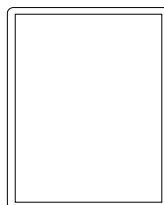

Setting is correct.

**Horizontal ripples**



Too hot! Risk of jamming! Decrease the temperature by selecting a lower pouch thickness setting.

**6**



**IMPORTANT**

Never attempt to laminate the following items:

- Leaves or other organic material – moisture will be boiled out, potentially ruining the lamination, damaging the electronics in the machine and creating risk of electric shock.
- Wax crayon drawings – the wax will melt, destroying the drawing. Molten wax could be extruded into the machine and cause extensive damage.
- Documents printed on thermal paper or Polaroid-type instant photos – the images will disappear.
- Any item that is creased or which has irregular thickness – it could cause a jam or damage the rollers.
- Artwork assembled with glue or incorporating glitter-glue. The glue will melt and run into the laminator.
- Any item that is not heat-resistant.

**7**

Before turning off the machine, allow the rollers to cool evenly by putting the machine in the 'Cold' mode. This can be done by pressing "SET" repeatedly until "COL" shows on the control panel.

Allow the laminator to run for 5 minutes before turning off the power.



**CAUTION**

If the laminator is not going to be used for a long time, unplug it from the power socket.

# Essential Information

- Never insert a pouch until the previous lamination has been removed from the machine. Failure to do so could cause a jam.
- The maximum capacity of this machine (pouch + contents) is 1.0mm.
- Should a miss-feed or jam occur, press **"REV"** to eject the pouch.

## Cold Lamination

The majority of lamination is done using pouches that are coated with adhesive that melts at high temperature. However, pouches coated with pressure-activated adhesive - so-called cold lamination pouches - are also available.

If you wish to use cold lamination pouches, turn on the **red** switch at the back of machine, press **"PWR"** to display the control panel and then press **"SET"** repeatedly until **"COL"** shows. The machine will then go into cold laminating mode. Cold Laminating can now begin.

If the machine is still warm from previous hot lamination and you wish to now use cold lamination pouches, press **"SET"** repeatedly until **"COL"** shows. **"Cooling"** will flash in the control panel while the rollers cool down. **"Cooling"** will stop flashing and **"Ready"** will appear when the desired temperature has been reached. Cold Laminating can now begin.

## Maintenance

We recommend that you regularly inspect the rollers for signs of pouch adhesive on the rollers and remove it with a soft cloth and alcohol (surgical spirit, rubbing alcohol or methylated spirit) when necessary. Do not use white spirit, petrol or any other solvents as they could damage the silicone rollers. Do not use sharp or abrasive tools when cleaning the rollers.

The inner faces of lamination pouches are coated with an adhesive that becomes molten at high temperatures. When a pouch is completely filled, this adhesive will usually be absorbed by the paper in the pouch. However, some adhesive may be squeezed out of the pouch and onto the rollers. If a pouch is not completely filled, a great deal of adhesive can be squeezed out onto the rollers.



### IMPORTANT

Sticky rollers can cause pouches to jam, so it is important to keep them clean.

To access the rollers, disconnect the machine from the electricity supply, allow it to cool, and then remove the top cover which is retained by two screws at the back. Use caution if the machine has been used recently – the top cover, the rollers and adjacent components may still be hot!

If you wish to clean the rollers while they are turning, first press **"SET"** repeatedly until **"COL"** shows so that the machine goes into "cold lamination" mode and allow it to cool down.

Remove the top cover only. Do not further dismantle the machine – risk of electric shock! Use extreme caution – take care that hair, clothing, jewellery, etc. does not become trapped by the rollers.

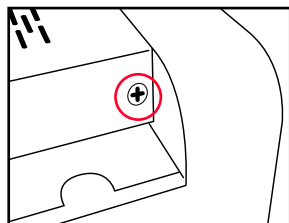

Phillips Screw x2 at the rear

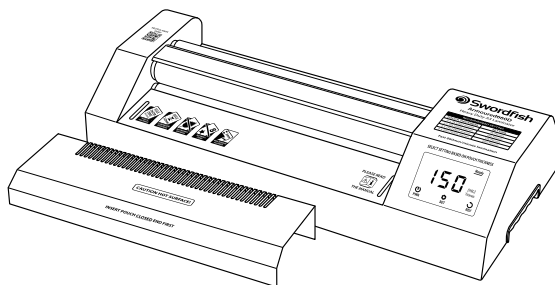

# Cleaning

The outer case of the machine may be wiped clean with a moist cloth. Do not allow water to spill inside the laminator – risk of electric shock.



## IMPORTANT

Do not use aerosol cleaners – or any other aerosol product – on, or near, this machine (or any other electrical appliance) as the propellant may be flammable.

# Troubleshooting

**The PWR does not appear when the laminator is turned on.**

Please ensure that the plug is firmly inserted into the 13Amp power socket and the power lead is firmly inserted into the back of the machine. Check that the isolating switch on the back of the machine is in the “on” position.

**White spots or cloudy areas appear on the lamination.**

The temperature of the machine is too low – the adhesive inside the pouch has not melted completely. Either use a thinner pouch or increase the pouch thickness setting – until perfect results are achieved.

**The lamination is creased, rippled or wavy.**

The temperature of the laminator is too high. Decrease the pouch thickness setting or use a thicker pouch.

**The edges of the pouch are wavy.**

If a number of smaller pouches have previously been laminated, the temperature of the rollers will be uneven. Allow the machine to run for a few minutes so that the temperature can stabilise.

**If a pouch becomes jammed in the laminator.**

Press “**REV**” to activate to Reverse mode. Pull the pouch gently, if necessary, but do not use excessive force as this could damage the laminator mechanism. If the jammed pouch cannot be removed, turn the laminator off immediately and contact your retailer for assistance.

**Do not attempt to dismantle the laminator as this will invalidate your warranty and expose you to the risk of burn injuries and electric shock.**



To get the best results from your laminator and to avoid common lamination problems, scan this code with your smartphone.

# Have you seen the rest of the Swordfish range?

## Pencil Sharpeners



The Triple



Pointi



Trio

## Paper Shredders



1000XC Plus



1200XXCD

## Paper Trimmers



SlimLine Series  
A4, A3



Elite Series  
A3/A2

To find out more information on the full range of products, visit us at [www.snopakebrands.com](http://www.snopakebrands.com)

